

25/11/2022 10:50:08 AM

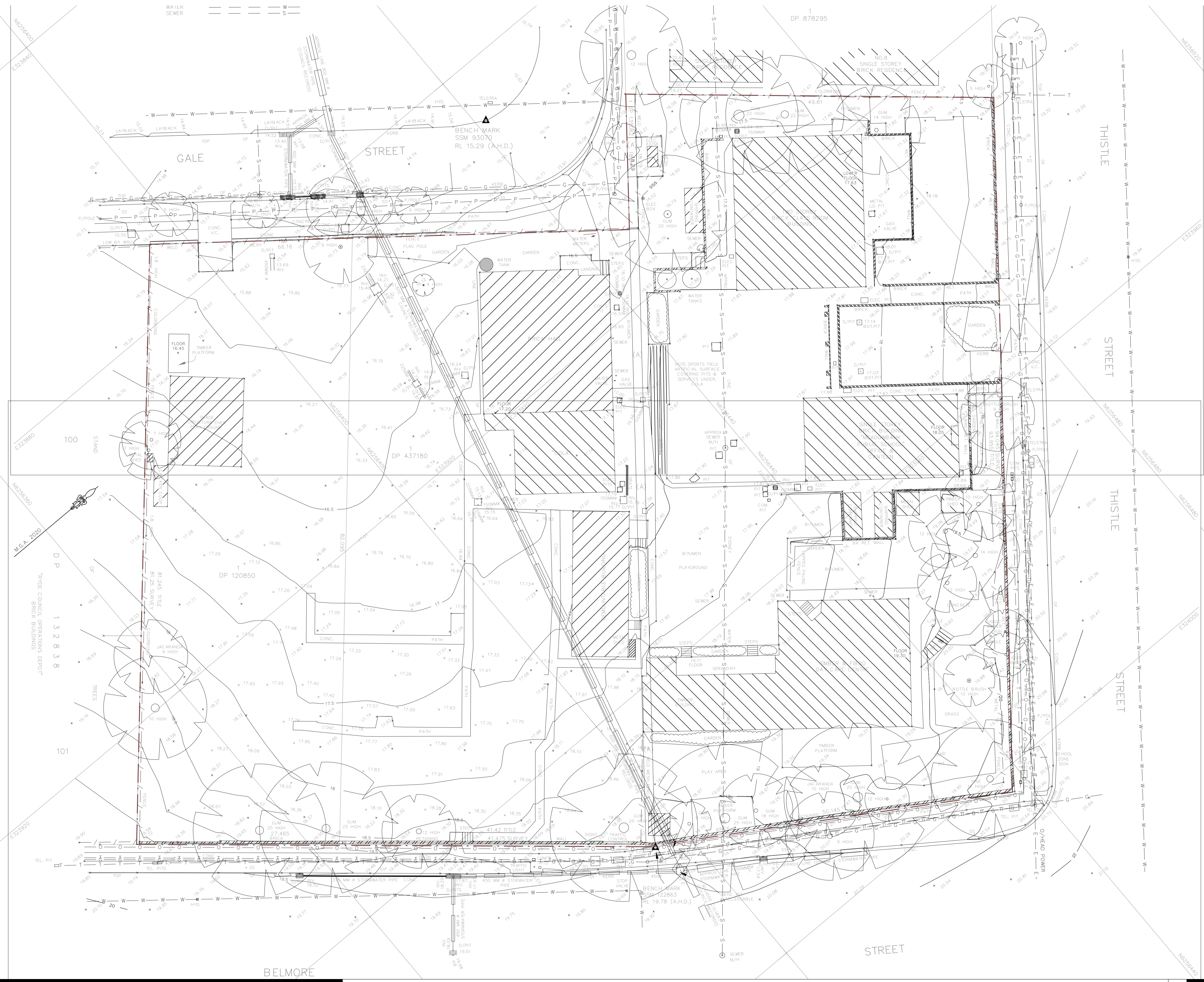

REV	BY	DATE	DESCRIPTION
A	PA	15/11/2022	PRELIMINARY ISSUE
A	PA	25/11/2022	ISSUE FOR DA

CLIENT DETAILS



Public Works

PEDAVOLI ARCHITECTS PTY LTD
 LEVEL 2
 458-468 WATLE STREET
 ULTRAO NSW 2007 AUSTRALIA
 T: +61 2 9291 0000
 W: www.pedavoli.com.au

NOMINATED ARCHITECT:
 VINCE PEDAVOLI
 NSW ARB No. 5045



DRAWING NAME

EXISTING SURVEY

MEADOWBANK PUBLIC SCHOOL OPEN SPACE

CNR BELMORE ST AND THISTLE STREET
RYDE

SCALE 1:250 @ A1
 25 NOVEMBER 2022

PROJECT	PHASE	SERIES NUMBER	REVISION
3336 - DA - 00_011	A		

PRELIMINARY